



ROCKY MOUNTAIN REBAR

LENTON®

E-Mail (or timw@mpguam.com)

Fax Form 671 653 4704

Quote	Order	P/O #

Please Check:

Date: _____
Company Name: _____
Contact Person: _____
Contact Tel.: _____

Job Name: _____
Contact E-Mail: _____
Contact Fax: _____

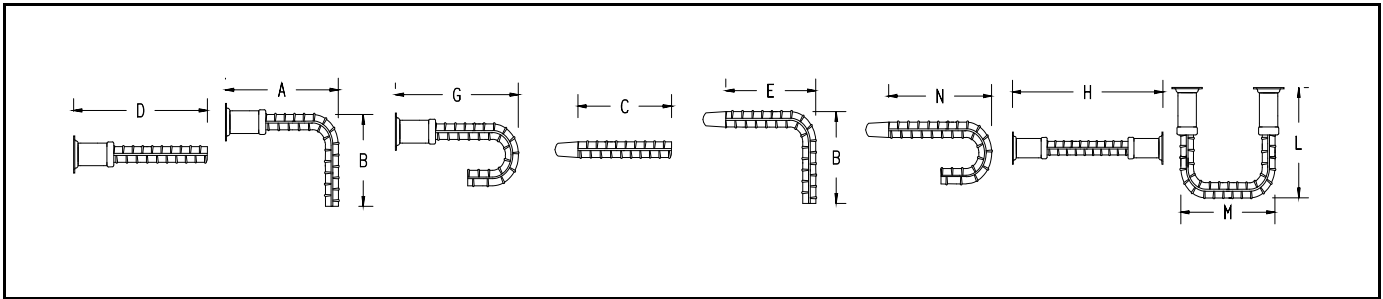

Qty.	Size *Bar	Black	"A" (Ft.)	"B" (Ft.)	"C" (Ft.)	"D" (Ft.)	"E" (Ft.)	"H" (Ft.)	MARK	Wt. Lbs.	Male	Female	Total
Exam.	4	Black	0.50	1.50						0	\$ -		
											\$ -	\$ -	\$ -
											\$ -	\$ -	\$ -
											\$ -	\$ -	\$ -
											\$ -	\$ -	\$ -
											\$ -	\$ -	\$ -
											\$ -	\$ -	\$ -
											\$ -	\$ -	\$ -
											\$ -	\$ -	\$ -
											\$ -	\$ -	\$ -
											\$ -	\$ -	\$ -
									Total	0		Total:	\$ -

*Unless noted otherwise all F/Saver Made with ASTM A615 Grade 60

Quoted by: _____

Rebar Size, US	Rebar Size, Metric	Hex Width W	Diamet er Ø	Height H	Length L
#3	10 mm	0.69"	—	2.25"	2.25"
#4	12 mm	0.69"	—	2.25"	1.94"
#5	16 mm	0.88"	—	2.25"	2.50"
#6	20 mm	1.06"	—	2.25"	3.13"
#7	22 mm	1.19"	—	2.25"	3.47"
#8	25 mm	—	1.38"	2.25"	3.66"
#9	28 mm	—	1.50"	2.50"	3.88"
#10	32 mm	—	1.75"	2.50"	4.03"
#11	36 mm	—	1.88"	2.50"	4.22"

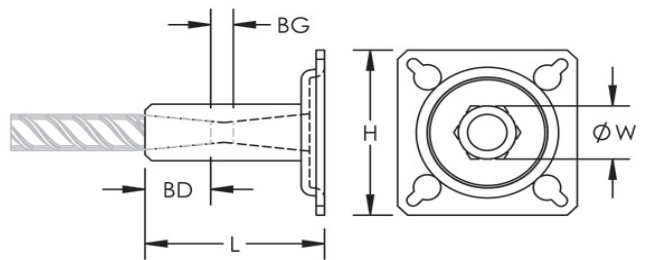

Designed to Meet

AASHTO, ABNT NBR 8548:1984, ACI 318 Type 1 (125% Specified Yield), ACI 318 Type 2 (Specified Ultimate), ACI 349, ACI 359, AS3600, CAN/CSA - N287.2/.3/.4, IBC Type 1 (125% Specified Yield), IBC Type 2 (Specified Ultimate), US Army Corps of Engineers